



Please read these instructions carefully before installation and keep them for future reference.



WARNING:

- Do not look directly at the lit lamp to avoid eye injuries.
- Always keep the floodlight away from any flammable surfaces or materials.
- Always check for damaged or worn out parts before using the floodlight. Broken parts will affect the operation of the floodlight.
- Do not use a pressure washer to clean this Floodlight.
- Do not modify the light in any way. Unauthorized modifications may compromise its function and safety, and could reduce the lifespan of this light. This floodlight is designed for specific applications.
- If the external flexible cable or cord of this luminaire is damaged, it should only be replaced by the manufacturer, service agent, or a similarly qualified individual to prevent any potential hazards.
- The light source in this luminaire cannot be replaced. When it reaches the end of its life, the entire luminaire must be replaced.
- This product contains a light source of energy efficiency class <E>

SAFETY WARNING FOR FLOODLIGHT:



This marking indicates that this product should not be disposed of with other household wastes.





Caution, risk of electric shock

Keep it away from children. Children should not be allowed to play with the light. Any attempt to open or alter the floodlight is prohibited unless performed by a professional electrician.

Do not attempt to replace or change the diode lights. If the protective glass is cracked or broken, it must be replaced before the floodlight can be used again.

DESCRIPTION OF SYMBOLS:

	Complies to relevant safety standards.
	To reduce the risk of injury, user must read instruction manual.

TECHNICAL DATA:

Item	Watt	Voltage	Lumen (Lm)	Beam Angle	DF	RA	Ingress Protection (IP)	Operation Temp	Lifetime	Energy rating	Color Temperature
17844	10W	220-240V 50Hz	1200	120°	0.5	>80	IP65	- 20°C ~ 40°C	25000h	E	6500K
17851	30W	220-240V 50Hz	3600	120°	0.9	>80	IP65	- 20°C ~ 40°C	25000h	E	6500K
17868	50W	220-240V 50Hz	6000	120°	0.9	>80	IP65	- 20°C ~ 40°C	25000h	E	6500K
17875	50W	220-240V 50Hz	6000	120°	0.9	>70	IP65	- 20°C ~ 40°C	25000h	E	3000K
17882	10W PIR	220-240V 50Hz	1200	120°	0.5	>80	IP65	- 20°C ~ 40°C	25000h	E	6500K
17899	30W PIR	220-240V 50Hz	3600	120°	0.9	>80	IP65	- 20°C ~ 40°C	25000h	E	6500K
17905	50W PIR	220-240V 50Hz	6000	120°	0.9	>80	IP65	- 20°C ~ 40°C	25000h	E	6500K
Installation height			1.8m-2.5m								
Time delay			Min: 7sec±2sec; Max: 7min±2min;								
Detection angle			120°								
Detection distance			3m±2m – 10m±2m(Radius)								

Remark:

- 1- With fast connector.
- 2- IP65 , IK05 Rated.
- 3- Class I.

INSTALLATION DIAGRAM

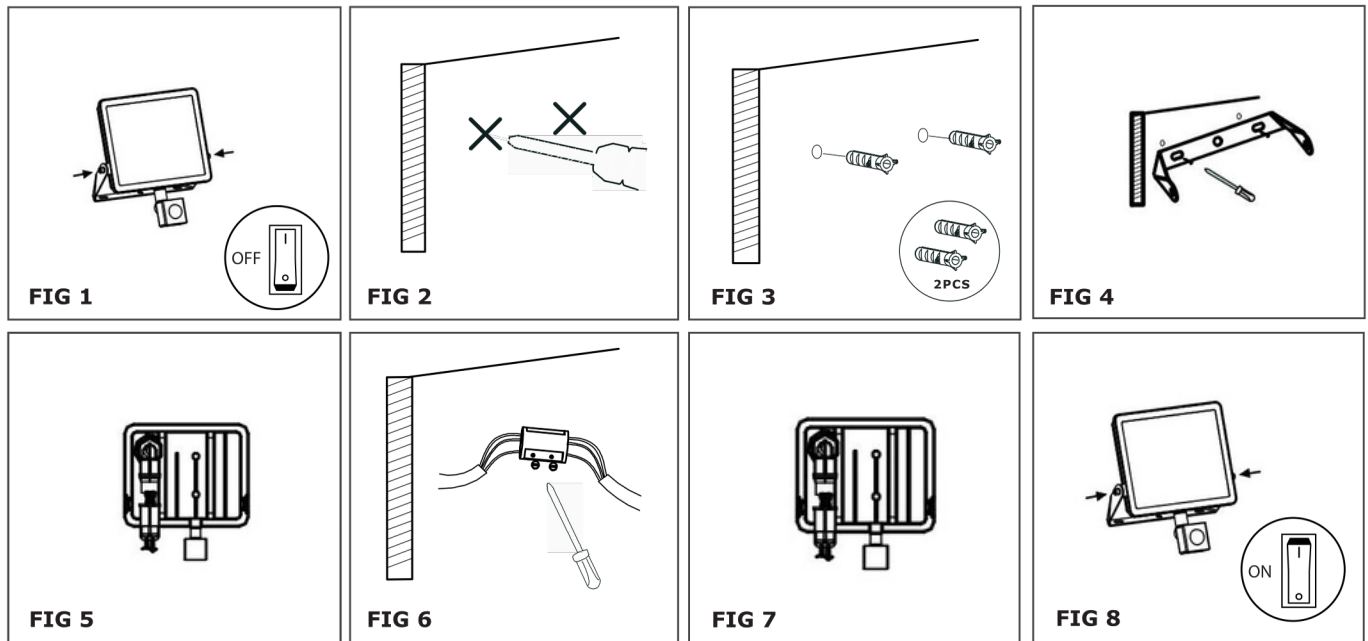

1. Switch off the power. Loosen the screws on the bracket, remove the bracket, and confirm the installation position.
2. Use an impact drill to create holes in the building surface.
3. Insert expansion bolts into the holes.
4. Secure the bracket in place.
5. Turn the connector counterclockwise, then pass the cable through the waterproof cap and connector one by one.
6. Connect the cable to the terminal: live wire to L, neutral wire to N, and ground wire to . Tighten the terminal block screw firmly.
7. Turn the connector and waterproof cap clockwise. Ensure the waterproof joint nut is securely tightened to prevent water leakage. Make sure the rubber covered part of the outer lead extends into the waterproof cap by at least 15mm to avoid the risk of water leakage.
8. Switch on the power and test the light.

MANUAL OVERRIDE FUNCTION: (For PIR motion sensor only)

To activate constant lighting mode:

- Turn off the power and then turn it on **within** 2 seconds.
The light will flash to confirm the switch to constant lighting mode.

To activate sensor mode:

- Turn off the power and then turn it on **after** 2 seconds.
The light will flash to confirm the switch to sensor mode.

IMPORTANT: The sensor needs 30 seconds to warm up and before it starts to work properly.



This marking indicates that this product should not be disposed of with other household waste throughout the UK and EU. To prevent potential harm to the environment or human health from uncontrolled waste disposal, please recycle it responsibly to encourage sustainable reuse of material resources.

www.paulrussells.com

CE UK CA    IP65 IK05